

LED Video Floor

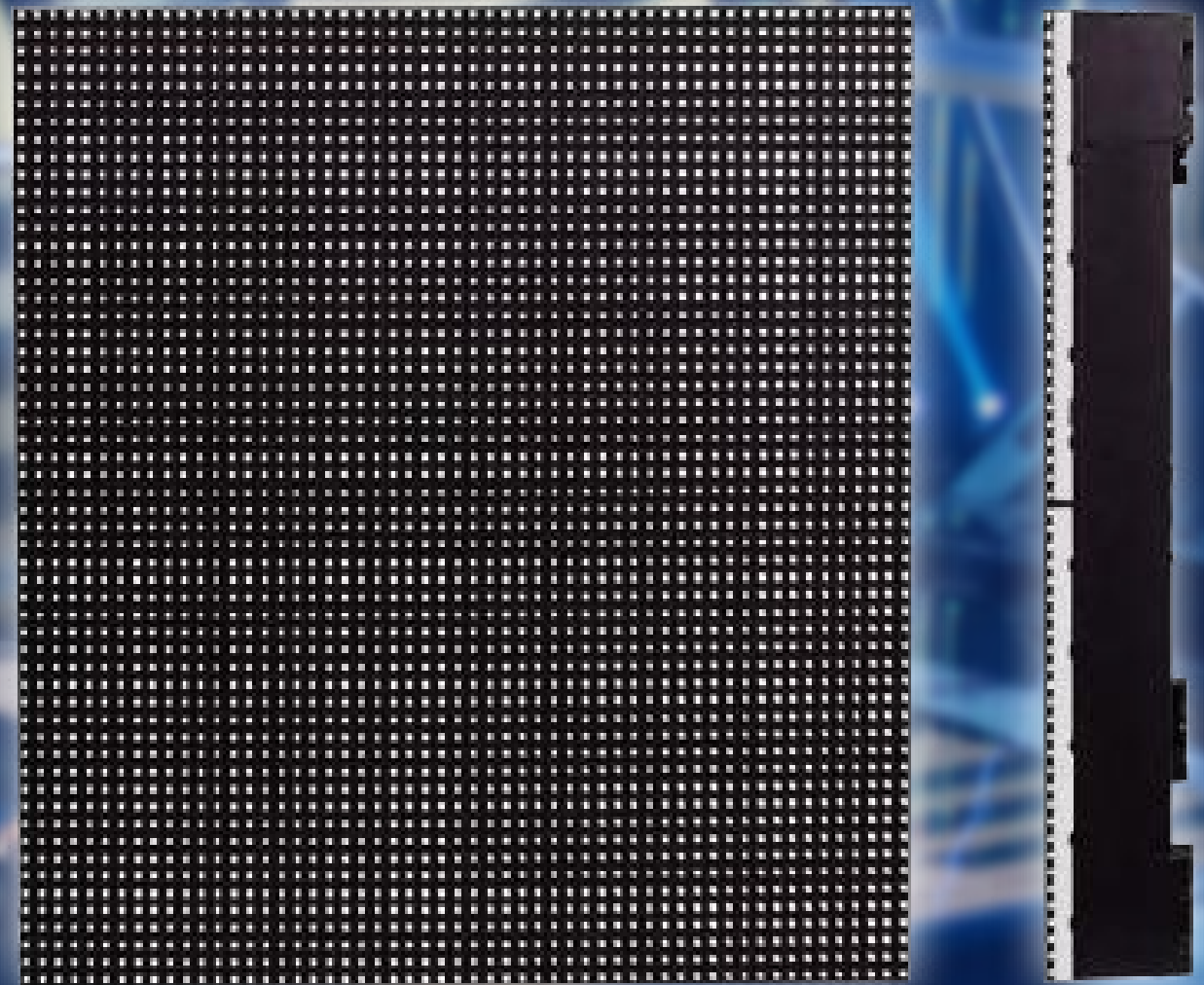

INDOOR/OUTDOOR UHD
RENTAL & FIXED P6-20MM



CABINET DETAILS



- CE, TUV and CSA certified
- Applicable to rental and fixed installation
- Strong rubber mask with very good
- Light transmission, mainly for anti-slip, water-proof, stain resistant
- Buffer damping design , no noise, long-time operation
- Point to surface supporting design
- Can withstand over 2000Kg/m2.
- Fan-less cooling using aluminum plate near the PCB and IC.

- 1 Power indicator light "P" indicates that power is connected.
- 2 Signal indicator light "S" indicates that signal is connected.
- 3 Button "T" is for testing the module inside the cabinet when there's no signal
- 4 Signal input and Output
- 5 Power input and Output
- 6 Pedestal foot combined with installation fastener is used for installation and fixing the cabinet.
- 7 Easy grip handles.
- 8 Fasten the installation fastener during non-ground installation
- 9 Power input location.
- 10 Signal input location.

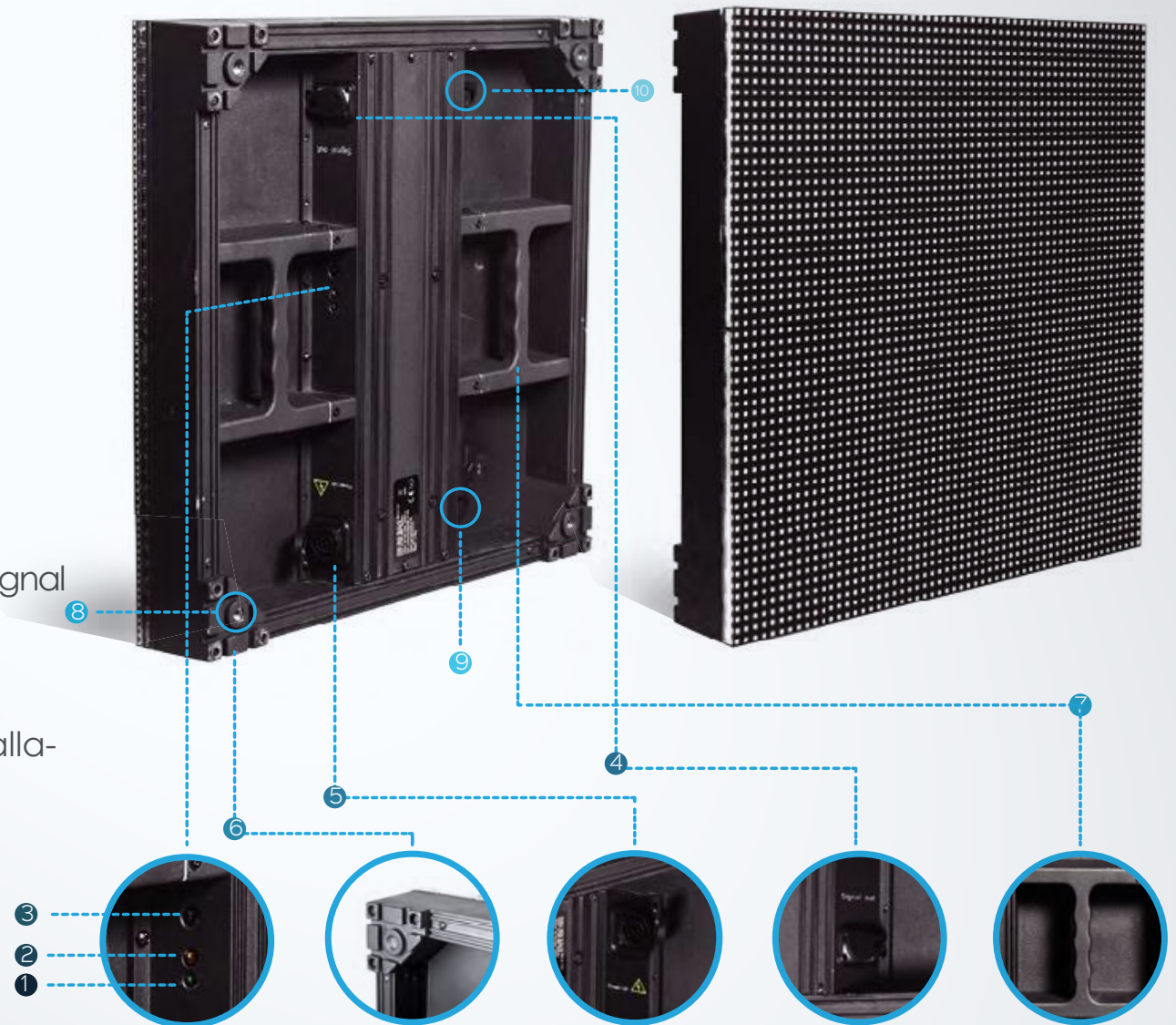

MODULE DETAILS

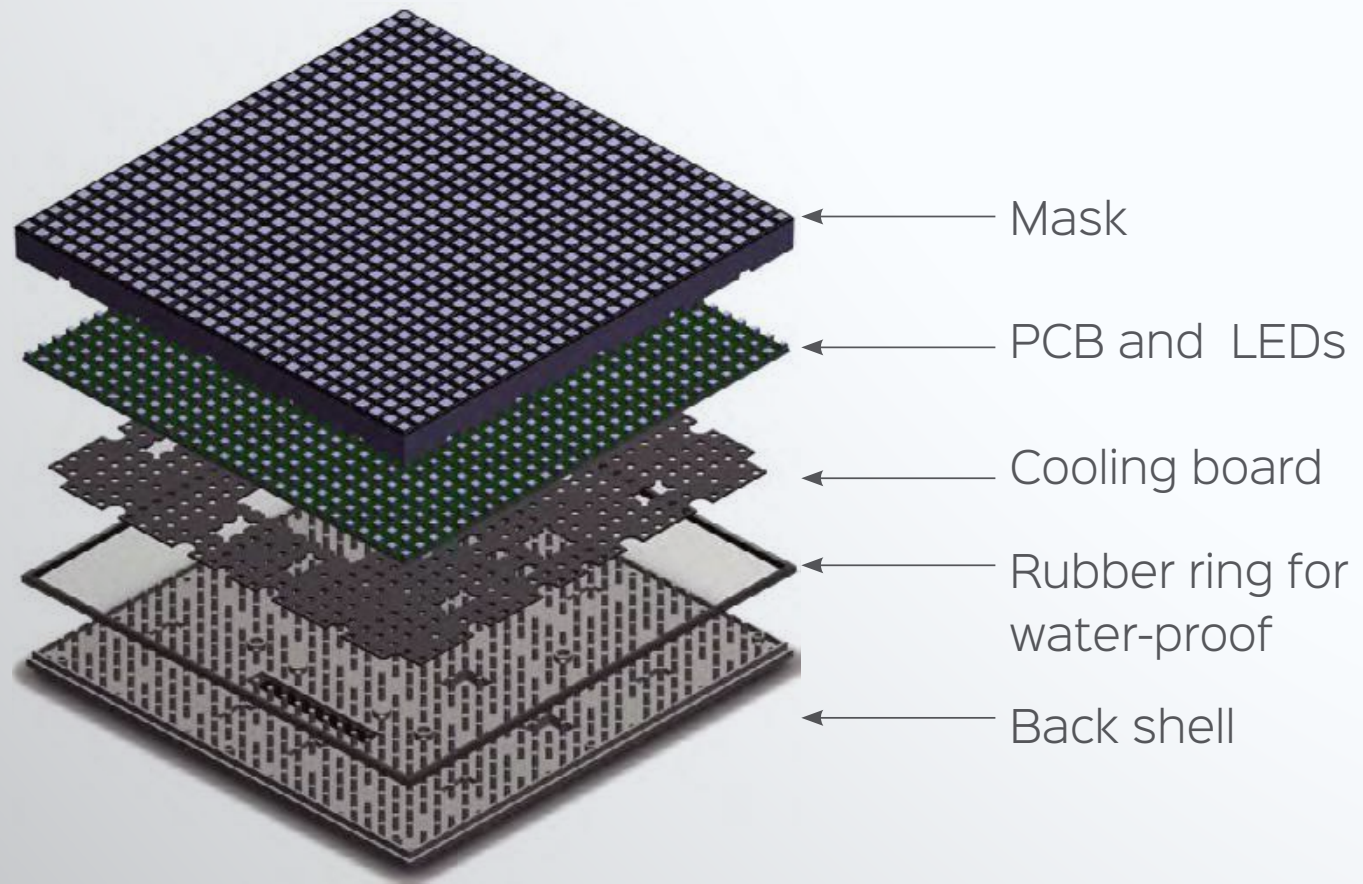

Soft rubber face mask



Module back shell support pillar

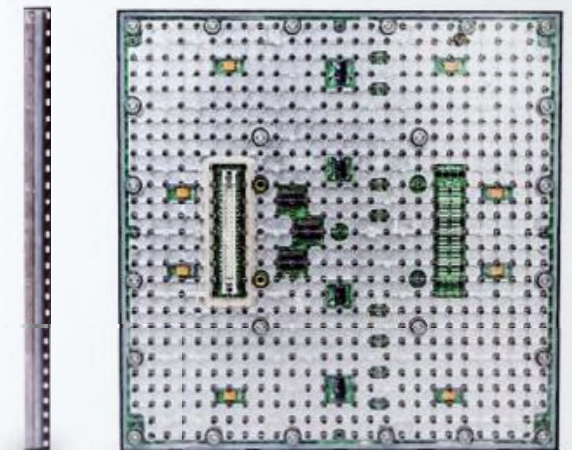
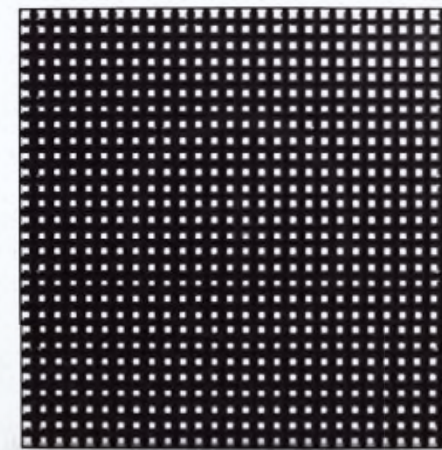

VIDEO FLOOR ACCESSORIES



Installation fastener
– It is used for connecting the cabinet and fastening the pedestals during installation.



Suction plate
– It is used for taking out panel from a whole screen.



Hoisting suite
– It is a special suite used for hoisting installation .

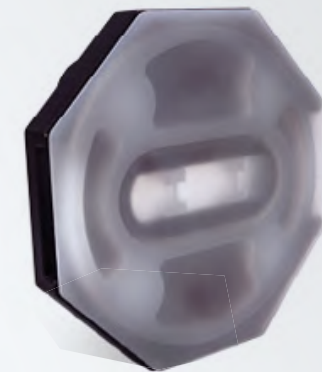

Silicon cushion
– It is used for protecting the flooring perfect for indoor events.



Adjusting foot
– Composed of the adjusting foot pedestal and the installation fastener, which can be used for vertical installation, and an adjusting function of the height can also be realized.

Adjusting foot pedestal
– It is used for supporting the floor plate during installation, and height can be adjusted freely.



Features

- High loading support
- Rubber seal
- 3 layers side rubber
- New designed buckle
- 3 pcs. rubber seal
- Fanless heat sink design
- Adjustable base support with aluminum plating

VIDEO FLOOR INSTALLATION

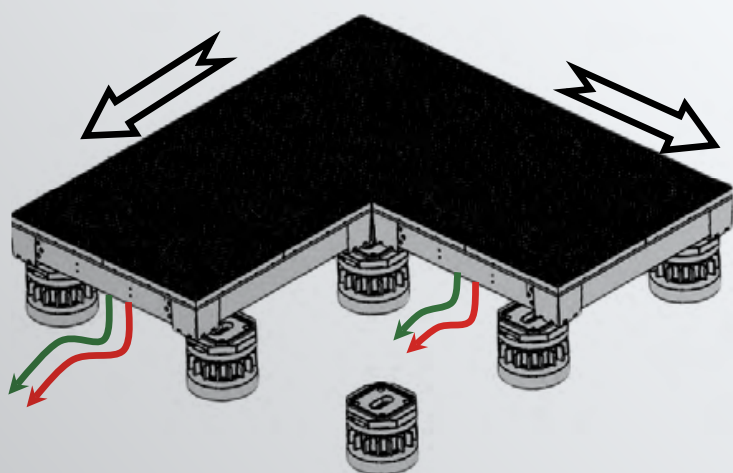
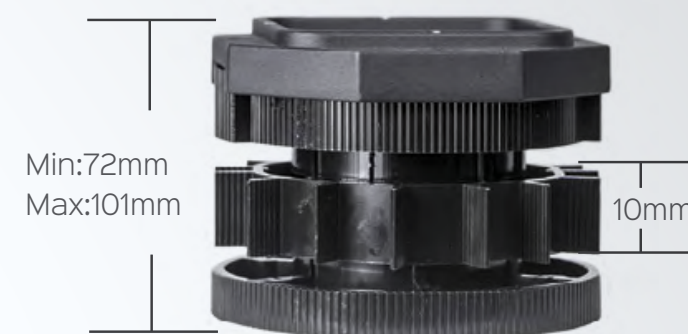
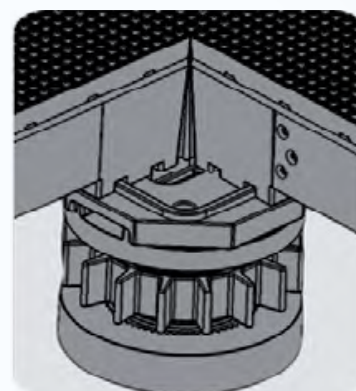
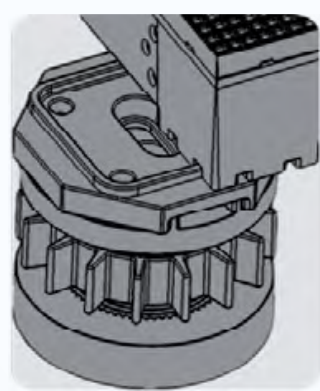
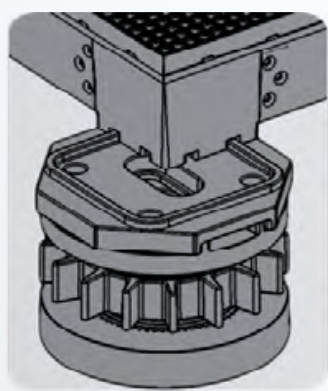
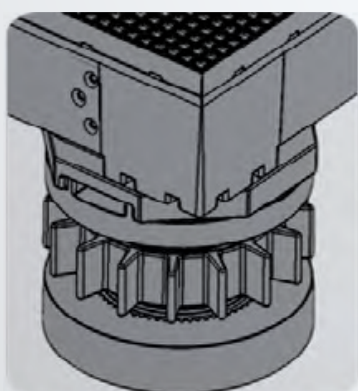
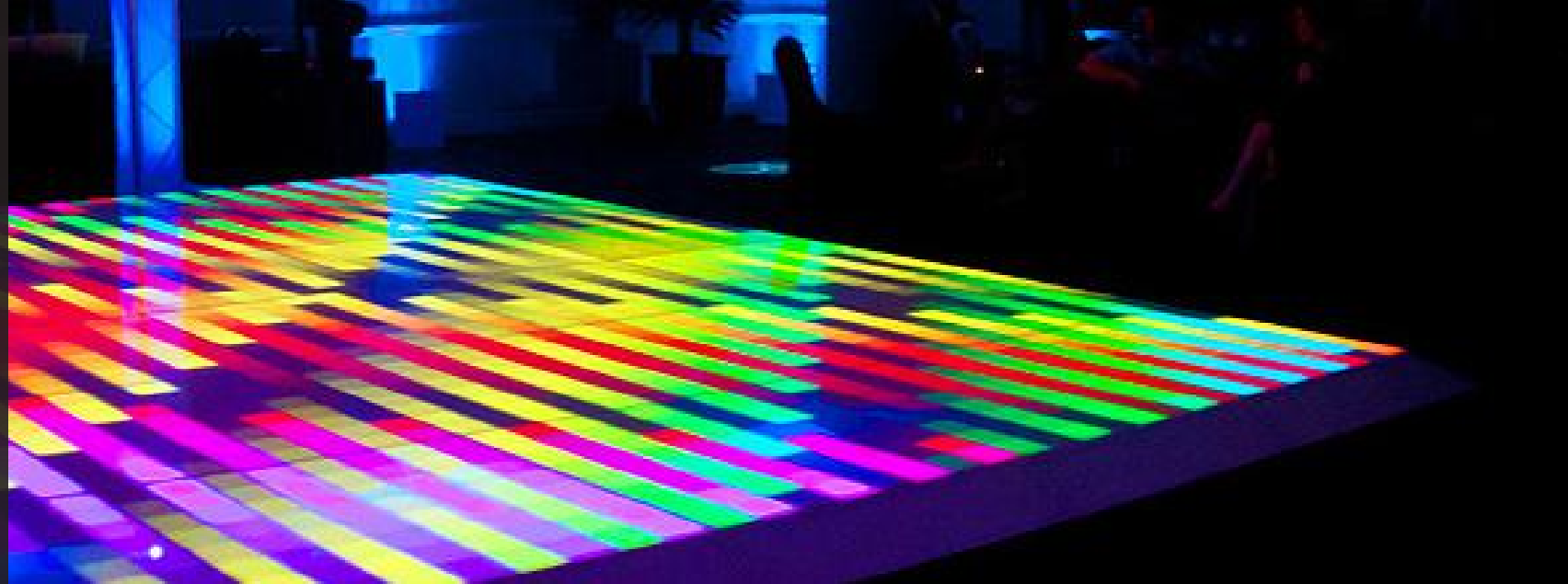

Normal installation

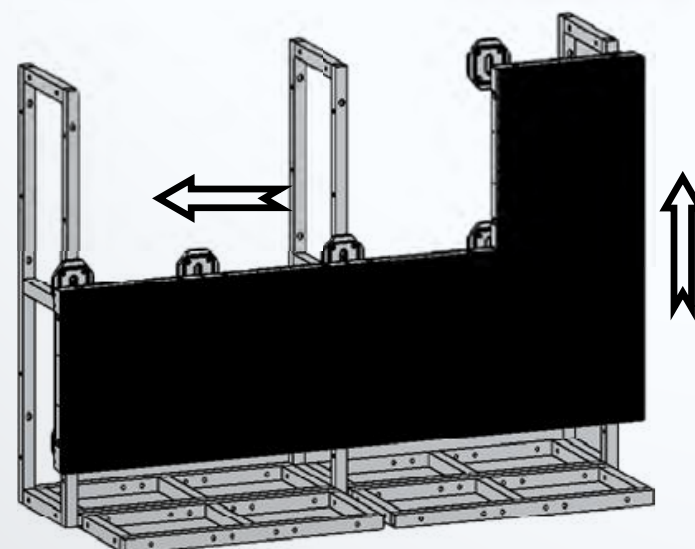

Standing installation



Hanging installation



PLEDCO HD DISPLAY

Our calibration technology reaches all possible X & Y coordinates ensuring you HD broadcasting experience is crystal clear.

SYSTEM CALIBRATION

All X & Y coordinates are kept in our client project database. When you order new tiles for an existing project we retrieve the original X & Y coordinates. This ensures during calibration all colors are matched properly. Typically, in video mode, no color differences are visible, however, if white has been set at 50% brightness, the user may see a slight difference in color.

1 COLOR ENHANCING

After calibrating with our Radiant PM-1400F Calibration System in a dark room, the wave length difference for each color will only be less than 0.01nm. Our patented control system allows users to select several different color spaces such as; 2k (REC709), 4K (REC2020) or create your own color space by using our user-friendly software.

2 COLOR COORDINATION PROCESS

The same batch of LED's with discrete distribution are all moved to PAL Mode Chroma Area through color coordinate calibration Technology.

Since each LED batch produced has different coordinates this requires precise color calibration, which in turn allows:

- ▶ Allows the LED display to show natural and vivid colors.
- ▶ Ensures that all LEDs have been color rendered consistently.

3 DIGITAL DATA REVISION

If a single pixel fails, the data will be read-out from the EEPROM and then re-wrote to the replacement chip. After this process the brightness value is calibrated again to ensure the uniformity of the entire system, thus providing easy and fast maintainability.

At the same time, the system records every displays' initial calibration data to avoid unevenly brightness caused by led attenuation. The updated screen brightness calibration data and recorded data, both ensure the uniformity of the display's brightness over a period of time.

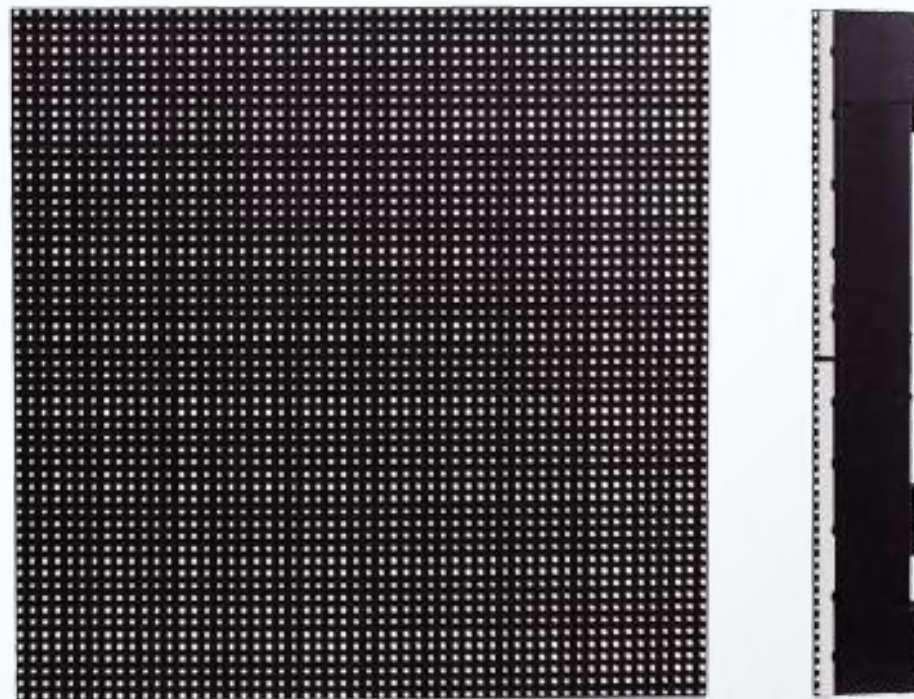

CONTROL SYSTEM 4K PROCESSING



MPU9000 SPECIFICATIONS

KEY FEATURES

Input			
Type	Channel	Connector	Details
DisplayPort	1	DisplayPort Standard	Supports DisplayPort 1.2. Max.3840×2160@30Hz
HDMI	3	HDMI Standard	Supports HDMI 1.4 Max.3840×2160@30Hz
DVI	2	DVI-I	Analog inputs not supported. DVI1 Supports dual-link Max.2560×1600@60Hz
SDI	1	BNC	Supports SMPTE 425M-Level A(3G-SDI), SMPTE 292M(HD-SDI), SMPTE 259M-C(SDI)
VGA	1	HD-15	Max.1080P@60Hz
YPrPb	1	3.5mm jack	Max.1080P@60Hz
Genlock	1	BNC	SD bi-level and HD tri-level sync, PAL, NTSC, 720p, 1080i/p, 576i/p, 480i/p
Output			
Type	Channel	Connector	Details
DisplayPort	1	DisplayPort Standard	Supports DisplayPort 1.2. Max.3840×2160@30Hz
HDMI	1	HDMI Standard	HDMI1.4.Suports 12bit deep color
DVI	1	DVI-I	Loop out from DVI2 input
SDI	1	BNC	Loop out from SDI input
Genlock	1	BNC	Loop out from Genlock Input
SPDIF	1	RCA	Supports standard S/PDIF for stereo LPCM or compressed audio up to 192 kHz
Headphone	1	6.5mm audio jack	Stereo Audio Output
LED Datalink	6	Neutrik etherCON	1Gbps/port
Others			
Control Methods	USB, Gigabit Ethernet, IR, HMI on the Font Panel		
Power	Neutrik powerCON connector, 100-240 VAC, 50-60 Hz, Max.25W		
Temperature	-10 ~ +50 °C		
Mechanical	472×375×90 mm		
Optional			
Fiber optical direct output, single mode or multi mode MPU9000 (FM or FS)			

- Integrated with SWITCH Monitor(2x2), Video Processor, Full-HD Media Payer and LED Display Controller
- Supports SD Card and mSATA SSD Mass Storage devices (up to 256GB for SSD and 200GB for SD)
- Available in fiber version with single mode or multi mode direct fiber output
- Supports DisplayPort 1.2, HDMI 1.4, dual-link DVI and 3G SDI Inputs
- Advanced Faroudja® video processing: MADi and DCDi
- Supports daisy chaining of monitors of up to four streams
- 6GB LED Display Data Link(optional fiber output)
- 6-axis color control independent of ACC
- 4K×2K screen resolution support
- Supports Gigabit Ethernet
- Built-in 6.5mm audio jack
- SPDIF Output by coaxial
- Supports Genlock
- Built-in Monitor
- 16bits Process



PRODUCT FEATURES

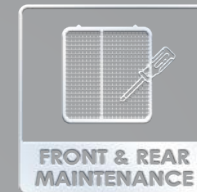

Custom designed by an industry leading Canadian engineer, our VIDEO FLOOR SERIES is equipped with automatic brightness technology to overcome any lighting conditions while delivering HD imagery.

SPECIFICATIONS

OUTDOOR SERIES

OUTDOOR SERIES	PO-6.2	PO-8.9	PO-10.4	PO-17.8	PO-20.8
Pixel Pitch	6.25mm	8.93mm	10.42mm	17.86mm	20.83mm
LED Configuration	SMD2727N SMD2727H	SMD3535-N SMD3535-H	SMD3535-N SMD3535-H	SMD3535-N SMD3535-H	SMD3535-N SMD3535-H
Pixel Density	25600/m ²	12544/m ²	9216/m ²	3136/m ²	2304/m ²
Unit Resolution	80*80	56*56	48*48	28*28	24*24
Module Resolution	40*40	28*28	24*24	14*14	12*12
Scanning Mode	1/8	1/4	1/4	Static	Static
Brightness(cd/sqm)	≥ 3000 ≥ 4000(H)	≥ 4000 ≥ 5000(H)	≥ 2800 ≥ 3800(H)	≥ 4000 ≥ 5000(H)	≥ 3500 ≥ 4500(H)
Refresh Frequency	≥ 800Hz ≥ 2000Hz	≥ 800Hz ≥ 1200Hz ≥ 2000Hz	≥ 800Hz ≥ 1200Hz ≥ 2000Hz	≥ 800Hz ≥ 1200Hz ≥ 2000Hz	≥ 800Hz ≥ 1200Hz ≥ 2000Hz
Power Consumption (max/avg)(W/pc)	180/60	180/60	150/50	180/60	150/50
Gray Scale	≥ 12bit ≥ 16bit	≥ 12bit/≥ 14bit ≥ 16bit	≥ 12bit/≥ 14bit ≥ 16bit	≥ 12bit/≥ 14bit ≥ 16bit	≥ 12bit/≥ 14bit ≥ 16bit
Unit Size(mm)	500(W) × 500(H) × 82(D)				
Unit Weight	13kg				
Module Size(mm)	250(W) × 250(H)				
Loading Capacity(/sqm)	2000kg				
View Angle	H1 20°/V1 20°				
IP Level(front/rear)	IP54/IP65				
Control System	NOVA/DBSTAR/LINSN				
Working Temperature	-30°C - +50°C				
Operating Humidity	10-90% RH				

INDOOR SERIES

INDOOR SERIES	PI-6.2	PI-8.9	PI-10.4	PI-17.8	BI-20.8
Pixel Pitch	6.25mm	8.93mm	10.42mm	17.857mm	20.83mm
LED Configuration	SMD2020-N SMD2020-H	SMD3528	SMD3528	SMD3528	SMD3528
Pixel Density	25600/m ²	12544/m ²	9216/m ²	3136/m ²	2304/m ²
Unit Resolution	80*80	56*56	48*48	28*28	24*24
Module Resolution	40*40	28*28	24*24	14*14	12*12
Scanning Mode	1/5	1/4	1/4	Static	Static
Brightness(cd/sqm)	≥ 1000/≥1500	≥ 1500	≥ 1000	≥ 1500	≥ 1200
Refresh Frequency	≥ 800Hz ≥ 2000Hz	≥ 800Hz/≥1200Hz ≥ 2000Hz	≥ 800Hz/≥1200Hz ≥ 2000Hz	≥ 800Hz/≥1200Hz ≥ 2000Hz	≥ 800Hz/≥1200 ≥ 2000Hz
Power Consumption (max/avg)(W/pc)	180/60	180/60	150/50	180/60	150/50
Gray Scale	≥ 12bit ≥ 16bit	≥ 12bit/≥ 14bit ≥ 16bit	≥ 12bit /≥14bit ≥ 16bit	≥ 12bit /≥14bit ≥ 16bit	≥ 12bit /≥14bit ≥ 16bit
Unit Size(mm)	500(W) × 500(H) × 82(D)				
Unit Weight	13kg				
Module Size(mm)	250(W) × 250(H)				
Loading Capacity(/sqm)	2000kg				
View Angle	H1 20°/V1 20°				
IP Level(front/rear)	IP54/IP65				
Control System	NOVA/DBSTAR/LINSN				
Working Temperature	-30°C - +50°C				
Operating Humidity	10-90% RH				



CUSTOMER SERVICE

At PLEDCO, we strongly emphasize the importance of customer relationships, and their trust in our products. Our key to lasting relationships focuses on delivering world-class LED products, while promising exceptional customer service and reliability, ensuring our clients a relaxing experience. PLEDCO is recognized as an industry leading LED total solution provider, from initial inquiry to after sales, our heavily trained team will guide you step-by-step through the entire process of your LED project.

Installation Support

Our skilled technicians can professionally install your LED Displays without disturbing your projects schedule. Mitigation and problem-solving are inevitable during the installation process, and PLEDCO's installation "Gurus" have the experience, know-how, and technical expertise to handle nearly any situation. We are able to provide you with all the required documents including; specification sheets, system diagrams, complete display and structure elevation drawings, and 3D rendering if required. As your dedicated total solution provider, we promise to be there step-by-step guiding you through your project, from initiation to closing.

24/7 Technical support via online or phone

Our phone and online live support systems enable us to provide 24/7 technical assistance. If you require urgent assistance, our skilled technicians are always ready to help, regardless of difficulty. Technicians are required to pass intensive training and testing to ensure issues are dealt-with professionally and accurately, while emphasizing the importance of your project's

Warranty & Maintenance

With over 20 years of combined professional experience, our internationally exposed engineers have specially designed and developed LED Display solutions to cope with harsh environments and withstand extreme temperatures. However, in the event of a problem, our highly experienced technical support team promises minimal display downtime by utilizing our bullet-proof troubleshooting expertise. Nearly all of Pledco's products include a 5-year warranty, with optional extensions available upon request.

Parts Availability for the Next 15 Years

Our manufacturing facility produces all the parts used assemble our LED displays. More importantly, we own all the technology, molds and PCB layout designs that are used to develop these parts. This provides us with the reliability knowing exactly what materials are being used and ensures the quality of our products can easily be managed directly from the production level. One of the biggest after-sales issues a client could have is being able to receive replacement LEDs that have been recalibrated exactly the same as the display when first produced. PLEDCO is one of the few companies in the world who utilizes the international HD NTSC REC-709 calibration in LED display, thus making it possible for us to provide our clients the exact same LEDs to match their display by using Radiant's camera technology.



PLEDCO LTD.
2/F Flat Roof 167 Lockhart Road
Hong Kong

pledco.com
info@pledco.com
worldwide: 1-855-717-2606